

EST stainless steel type plate

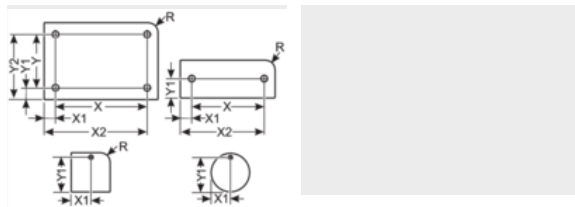

Product information

V4A stainless steel label plates to be used as type plates. Fastened with either rivets or screws.

Marking is only possible with a laser marking system (e.g. mp-LM*, pulsar) or with an engraving system suitable for engraving stainless steel (e.g. CAM).

Special design for demanding environments like

- Chemical and petrochemical industry
- in the mining industry
- in the ship building industry
- in wind energy plants
- in the food industry

* polished on one side

* maximale Beschriftungsgröße der mp-LM-Baureihe = 120 x 120 mm

A suction and filter unit is absolutely necessary for laser cutting to comply with legal regulations on health protection.

Information, conformities and approvals



Article	Order No.	Color	Material thickness mm	Printable area mm	No. characters/lines	Number x Holes mm	Software Article	PU pcs.
Stainless steel single label								
EST 30x30 R5, 1x4,0MM	8605148007	Stainless steel brushed	1	30 x 22	16 / 6	1x 4.0	A62	90
EST 52x26 R3, 2x2,5MM	8605148006	Stainless steel brushed	1	37 x 26	20 / 7	2x 2.5	L16	40
EST 74x37 R3, 4x2,5MM	8605148005	Stainless steel brushed	1	59 x 37	32 / 10	4x 2.5	L15	20
EST 84x54 R3, 4x2,5MM	8605148004	Stainless steel brushed	1	69 x 54	38 / 15	4x 2.5	L14	10
EST 85x55 R3, 4x2,5MM	8605148008	Stainless steel brushed	1	74 x 55	41 / 16	4x 2.5	L18	10
EST 100x60 R5, 4x3,7MM	8605148003	Stainless steel brushed	1	82.5 x 60	45 / 17	4x 3.7	L13	10
EST 120x70 R5, 4x3,7MM	8605148002	Stainless steel brushed	1	102.5 x 70	56 / 20	4x 3.7	L12	10
EST 139x85 R5, 4x3,7MM	8605148001	Stainless steel brushed	1	121.5 x 85	67 / 25	4x 3.7	L11	10
EST 139x139 R5, 4x3,7MM	8605148000	Stainless steel brushed	1	121.5 x 139	67 / 40	4x 3.7	L10	10

1) Not suitable for labeling with mp-LM



EST stainless steel type plate

Article	Order No.	Color	Material thickness mm	Printable area mm	No. characters/lines	Number x Holes mm	Software Article	PU pcs.
1) Not suitable for labeling with mp-LM								

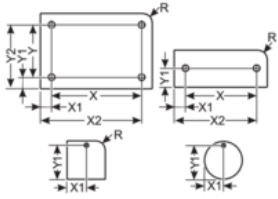

Article	Order No.	Outside radius R mm	Drill hole pitch X mm	Drill hole pitch Y mm	Drill hole position X1 mm	Drill hole position Y1 mm	Drill hole position X2 mm	Drill hole position Y2 mm	Radius mm	Hole patterns
EST 30x30 R5, 1x4,0MM	8605148007	5			15	26			5	1x 4.0
EST 52x26 R3, 2x2,5MM	8605148006	3	42		5	13	47		3	2x 2.5
EST 74x37 R3, 4x2,5MM	8605148005	3	64	27	5	5	69	32	3	4x 2.5
EST 84x54 R3, 4x2,5MM	8605148004	3	74	44	5	5	79	49	3	4x 2.5
EST 85x55 R3, 4x2,5MM	8605148008	3	79	49	3	3	82	52	3	4x 2.5
EST 100x60 R5, 4x3,7MM	8605148003	5	90	50	5	5	95	55	5	4x 3.7
EST 120x70 R5, 4x3,7MM 1)	8605148002	5	110	60	5	5	115	65	5	4x 3.7
EST 139x85 R5, 4x3,7MM 1)	8605148001	5	129	75	5	5	134	80	5	4x 3.7
EST 139x139 R5, 4x3,7MM 1)	8605148000	5	129	129	5	5	134	134	5	4x 3.7

1) Not suitable for labeling with mp-LM

Material properties



V4A stainless steel

Thermal properties



Temperature / temperature range

-80 °C - 500 °C



EST stainless steel type plate

Fire properties



Fire classification

V0

Classification

ETIM 9: EC001288
ECLASS 14: 27144009
UNSPSC 26.0801: 39131504

General technical data



Assembly method

00000000001Label riveted into place 1Mounting the label with screws 0

Assembly method



Riveting system



Screw system

Labelling technology



Laser



Engraving