

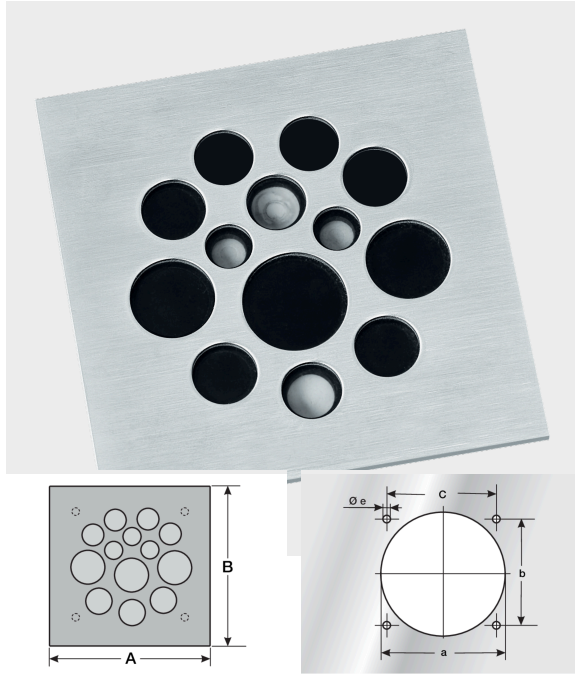

## KDP cablequick<sup>®</sup> Type 90 (90x90 mm)



### Product information

Efficient connection technology for terminal boxes, control cabinets for tool-free introduction of actuators, sensors, measuring and control instrumentation, optoelectronic, pneumatic lines and drive technology into a control panel. The stainless steel version is particularly suitable for application in the food and chemical areas. Integrated threaded bolts mean that no screws are visible from outside. Mounting set included in delivery.

- Aluminium & Stainless Steel are approved for railway technology (NFPA 130)
- V4A : 1.4571
- ALU : 3.3535
- ST : 1.0037

### Information, conformities and approvals



Article	Order No.	Color	No. Openings	Openings No. Ø mm	PU pcs.
KDP 90/13 V4A	87663118	Grinded	13	2x 3 mm - 6.2 mm 4x 4.5 mm 1 - 8.5 mm 4x 6 mm - 10 mm 2x 9 mm - 14 mm 1x 14 mm - 18 mm	

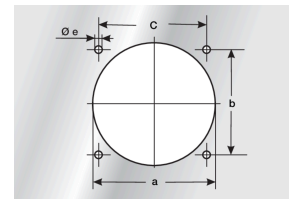
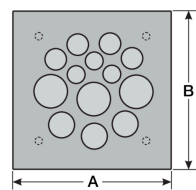

Article	Order No.	A mm	B mm	a mm	b mm	c mm	e mm
KDP 90/13 V4A	87663118	90	90	75	64	64	4.5

### Material properties



NBR / EPDM II



## KDP cablequick<sup>®</sup> Type 90 (90x90 mm)

### Thermal properties



Temperature / temperature range -45 °C – 90 °C

### Protection class



Protection class IP65

### Fire properties



Fire classification HB Housing: Seal:



Resistant to: Alcohol Greases Fuels Lyes Mineral oils Weak acids

### Technical information



LABS free



According to ISO 4892-2

### Conformity



RoHS (EC Directive 2011/65/EU)

### Approvals and operating permits



CSA approval



### Classification



ETIM 9: EC002624 || eClass 14: 27182815 || UNSPSC: 39121312 ||