

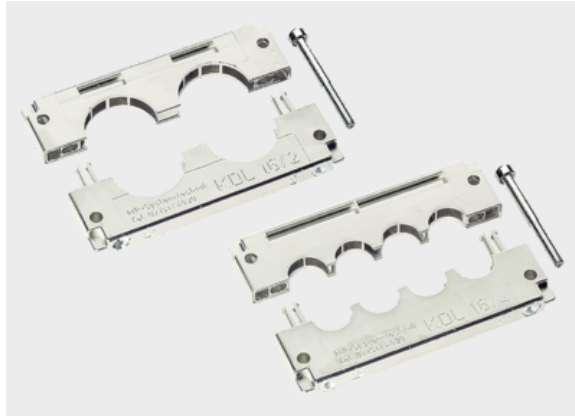

Cable entry system type KDL xx/xx-EMV



Product information

The cable entry system KDL/EMV is based on the cable entry system KDL. A conductive surface allows cable sheath interference to be discharged onto the control cabinet simply and without additional aids. Field-related interferences are discharged by the metalization. The KDL 16 /xx-EMV types fit on cut-outs for 16-pin plug connectors, the KDL 24 /xx-EMV types fit on cut-outs for 24-pin plug connectors by Harting or Wieland.

Information, conformities and approvals

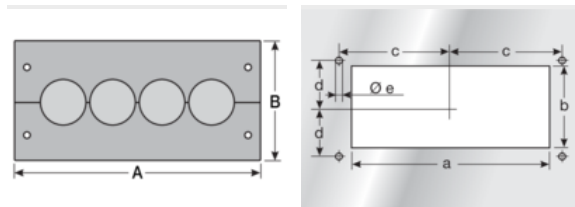

Article	Order No.	Color	No. Openings small / medium / large	PU pcs.
For standard cut-out size 16				
KDL 16/2-EMV 1)	87171020	Chrome	0 / 2	1
KDL 16/4-EMV 1)	87171022	Chrome	4 / 0	1
For standard cut-out size 24				
KDL 24/3-EMV 2)	87171024	Chrome	1 / 2	1
KDL 24/5-EMV 2)	87171026	Chrome	5 / 0	1
Enlarged cut-out for up to 15 pre-assembled cables				
KDL 2/10-EMV 3)	87171027	Chrome	10 / 0	1
KDL 3/15-EMV	87980021	Chrome	15 / 0	1
1) Replacement seal KDL16-EMV 8717102100 2) Replacement seal KDL 24-EMV 8717102500 3) Replacement seal KDL 2/10-EMV 87980020				
1) Replacement seal KDL16-EMV 8717102100 2) Replacement seal KDL 24-EMV 8717102500 3) Replacement seal KDL 2/10-EMV 87980020				



Cable entry system type KDL xx/xx-EMV

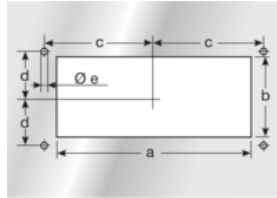
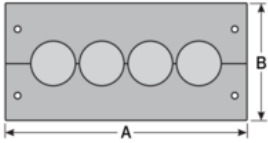

Article	Order No.	Installation height mm	A mm	B mm	a mm	b mm	c mm	d mm	e mm
KDL 16/2-EMV 1)	87171020	10	116	58	86	36	51.5	16	5.5
KDL 16/4-EMV 1)	87171022	10	116	58	86	36	51.5	16	5.5
For standard cut-out size 24									
KDL 24/3-EMV 2)	87171024	10	146	58	112	36	65	16	5.5
KDL 24/5-EMV 2)	87171026	10	146	58	112	36	65	16	5.5
Enlarged cut-out for up to 15 pre-assembled cables									
KDL 2/10-EMV 3)	87171027	10	146	90	120	60	65	32	5.5
KDL 3/15-EMV	87980021	10	146	122	120	96	65	48	5.5

1) Replacement seal KDL16-EMV 8717102100
2) Replacement seal KDL 24-EMV 8717102500
3) Replacement seal KDL 2/10-EMV 87980020

Material properties



Conductive coating on Polyamide 6.6 Polyamide 6.6 Polyamide 6.6

Thermal properties



Temperature / temperature range
-40 °C – 80 °C

Fire properties



Fire classification
V0

Conformity



RoHS (EC Directive 2011/65/EU)



Cable entry system type KDL xx/xx-EMV

Approvals and operating permits



GL approval

Classification

ETIM 9: EC002623
ECLASS 14: 27182804
UNSPSC 26.0801: 39121613

General information



Made in Germany